

# pipetman®

M96

**QUICKLY AND EFFICIENTLY PIPETTE IN MICROPLATES WITH CONFIDENCE**

96-channel Motorized Pipette

**Increase the productivity of your workflows with the all-in-one simple and intuitive PIPETMAN® M96.**

## Smart and Easy 96-channel Motorized Pipette

The intuitive interface on a large touchscreen assists you during your pipetting, whatever the application. Pipetting on 96-well microplates has never been this simple!

Create your protocols and choose your preferred pipetting parameters to handle various workflows.

## Flexible

PIPETMAN M96 is compatible with a large variety of SLAS-standard labware, and addresses different working habits with its pipetting options and improved ergonomics.

Different packaging types of PIPETMAN® DIAMOND Tips can be used with PIPETMAN M96. Optimized accessories allow for a better-organized working space with no additional footprint.

## Confidence and Improved Productivity

PIPETMAN M96 reproducibility eliminates any variability caused by repetitive pipetting tasks.

Results are reliable even at a high throughput thanks to the Gilson repeatability and performance standards.



**Contact Us for Further Information and Quote Requests.**

Visit [gilson.com/contactus](https://gilson.com/contactus)

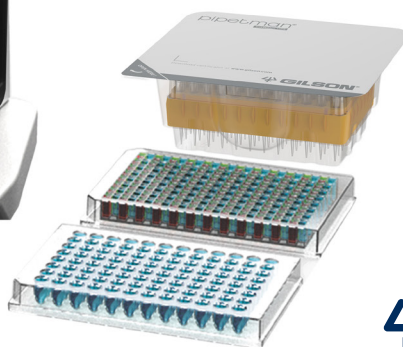

**GILSON®**



PIPETMAN M96 Connected models are smart, Bluetooth®-connected pipettes compatible with the Gilson application PipetteScope®.

**PIPETMAN M96 Connected models are available in the same countries as PIPETMAN® M Connected models.** Please contact your Gilson representative for more details.

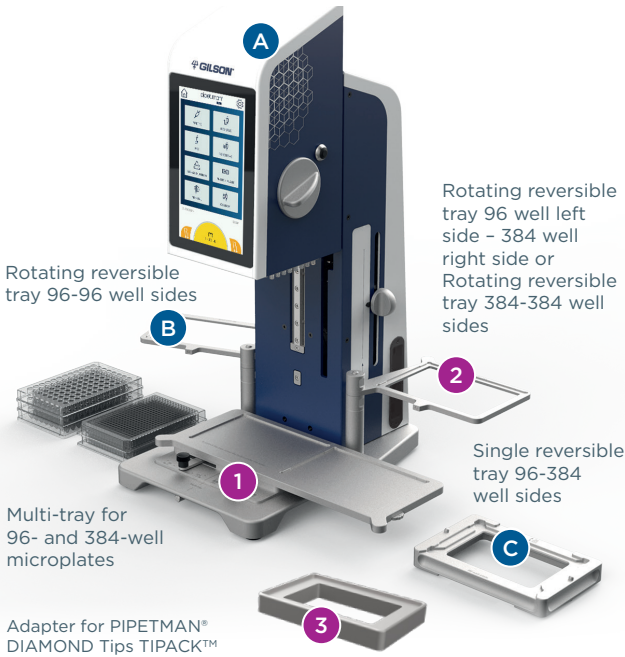

## Choose the Right PIPETMAN DIAMOND Tips for Your Need

PIPETMAN DIAMOND Tips offer a wide range of packaging according to your needs. They are designed to fit your PIPETMAN M96 perfectly and guarantee maximum accuracy and precision.

For increased productivity and minimal plastic waste, the use of Blister Refills and Reload Packs is recommended.

D200 tips are the reference tips for both P96x20M and P96x200M

\*DF30ST tips are recommended to pipette up to 30 µL, and DF100ST up to 100 µL, for both P96x20M and P96x200M

\*\*D300 tips are recommended to pipette volumes of liquids close to the nominal volume of the pipette, only for P96x200M



[gilson.com/contactus](http://gilson.com/contactus)

LT800626/B | ©2025 Gilson S.A.S.  
All rights reserved. All trademarks are the property of Gilson, Inc. and its subsidiaries.

## PIPETMAN® M96

| Model              | Part Number | Volume Range          |                 |             |
|--------------------|-------------|-----------------------|-----------------|-------------|
|                    |             | Standard Pipette Mode | Repetitive Mode | Custom Mode |
| P96x20M Connected  | FH10001     | 2-20 µL               | 1-20 µL         | 1-20 µL     |
| P96x200M Connected | FH10002     | 10-200 µL             | 5-200 µL        | 10-200 µL   |
| P96x20M            | FH10003     | 2-20 µL               | 1-20 µL         | 1-20 µL     |
| P96x200M           | FH10004     | 10-200 µL             | 5-200 µL        | 10-200 µL   |

## Complete Your PIPETMAN M96 with Accessories

PIPETMAN M96 is a compact, electronic 96-channel pipette equipped with accessories for optimal use with various SLAS-size microplates and labware.

| Part Description                                                                                             | Part Number |
|--------------------------------------------------------------------------------------------------------------|-------------|
| 1 Multi-tray for 96- and 384-well microplates                                                                | FH07005     |
| 2 Rotating reversible tray 96 well left side - 384 well right side                                           | FH07004     |
| Rotating reversible tray 384-384 well sides                                                                  | FH07003     |
| 3 Adapter for PIPETMAN® DIAMOND Tips TIPACK™                                                                 | FH07006     |
| A PIPETMAN M96 pipette                                                                                       |             |
| B Rotating reversible tray 96-96 well sides (provided with the pipette, and available as an extra accessory) | FH07002     |
| C Single reversible tray 96-384 well sides (provided with the pipette, and available as an extra accessory)  | FH07001     |

● Included in the PIPETMAN M96 box | ● Sold separately

## PIPETMAN® DIAMOND Tips

| Packaging Type               | Standard Tips                               | Sterilized Tips                                   | Sterilized Filter Tips                                                                                      |
|------------------------------|---------------------------------------------|---------------------------------------------------|-------------------------------------------------------------------------------------------------------------|
| Blister Refill (Recommended) | D200<br>D300**<br>DS200<br>(384- certified) | D200ST<br>D300ST**<br>DS200ST<br>(384- certified) | DF30ST*<br>DF100ST*<br>DF200ST<br>DF300ST**<br>DSF30ST*<br>(384- certified)<br>DSF200ST<br>(384- certified) |
| Reload Pack                  | D200                                        | -                                                 | -                                                                                                           |
| TIPACK™                      | D200<br>D300**                              | D200ST<br>D300ST**                                | DF30ST*<br>DF100ST*<br>DF200ST<br>DF300ST**                                                                 |



Contact Us for Pipette Tip Offers  
Visit [gilson.com/contactus](http://gilson.com/contactus)



SCAN ME!

Scan the QR code for more information.



GILSON®